

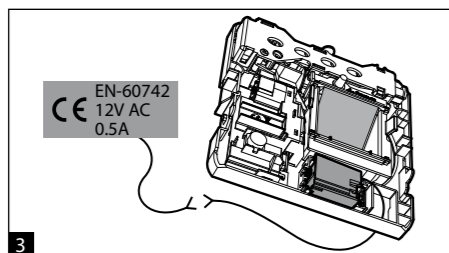

Aereco S.A.
9 allée du Clos des Charmes - Collégien
77615 Marne la Vallée Cdx 3 - FRANCE
tel: +33 1 60 06 26 63 - fax: +33 1 60 06 22 11
www.aereco.com

Плата питания 12V AC / 3V DC

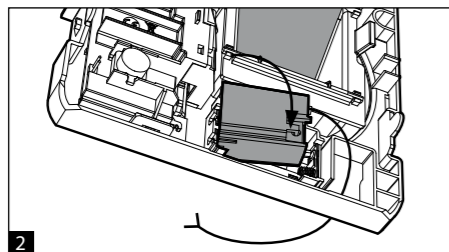
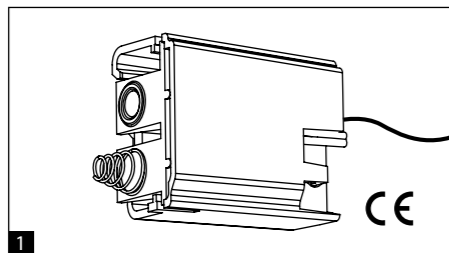

6

Измерение давления

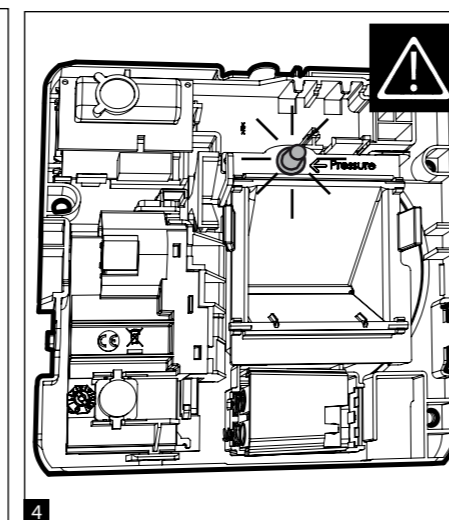
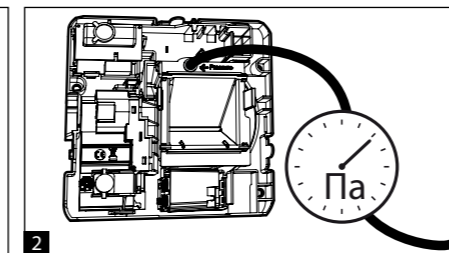
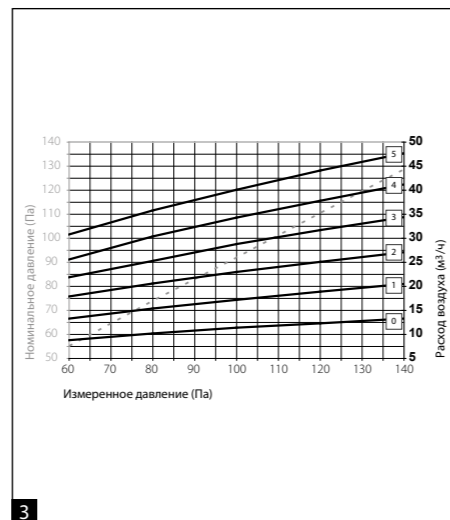
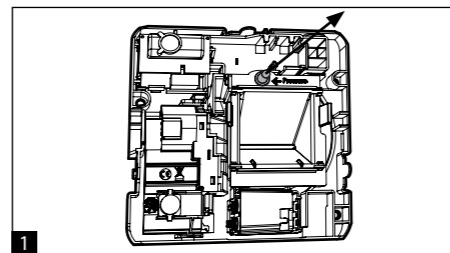

7

Установка расхода воздуха

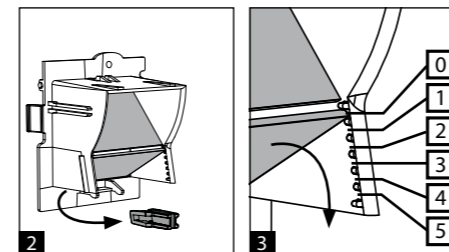
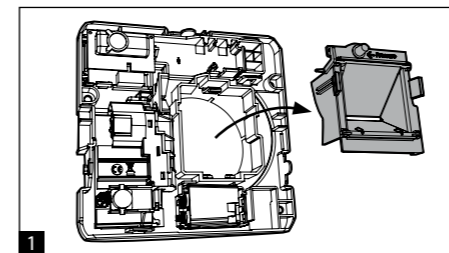

Ø 100 мм		
Позиция	Мин. расход воздуха (м³/ч) при 100 Па	Макс. расход воздуха (м³/ч) при 100 Па
0	12	80
1	18	90
2	24	100
3	30	110
4	36	120
5	42	130

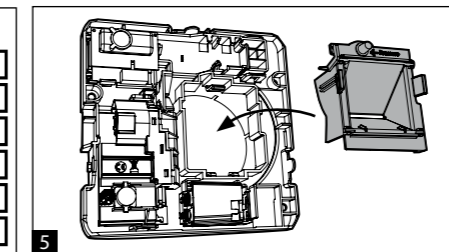
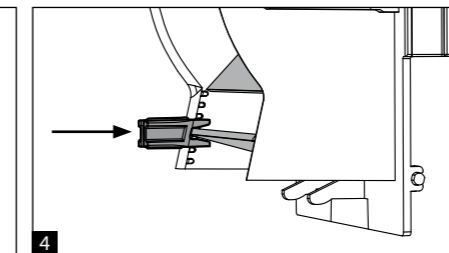

Ø 125 мм		
Позиция	Мин. расход воздуха (м³/ч) при 100 Па	Макс. расход воздуха (м³/ч) при 100 Па
0	12	70
1	18	80
2	24	90
3	30	100
4	36	110
5	42	120

8



Специальные версии

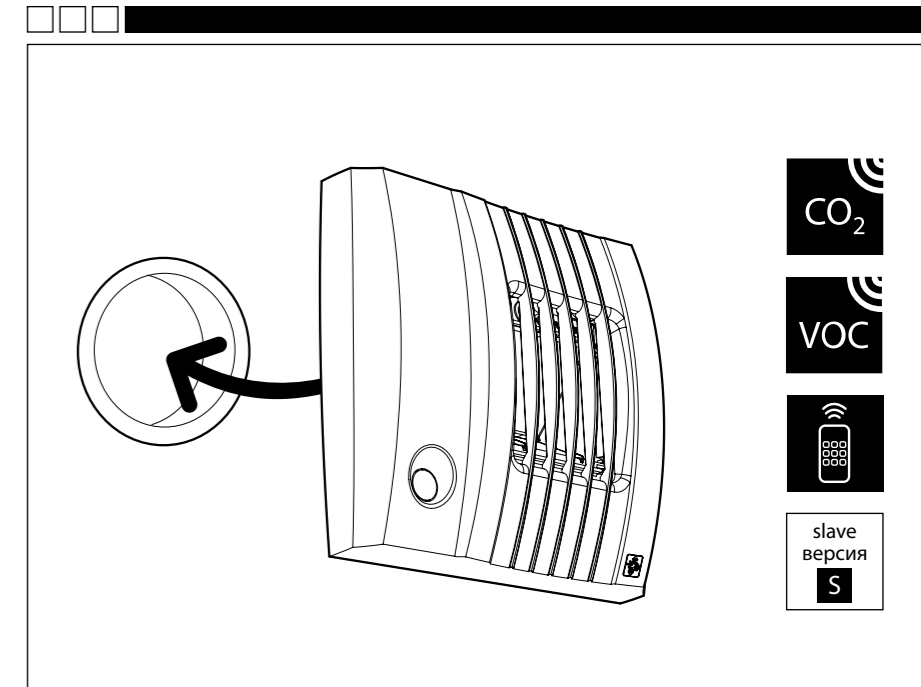

D4587_B

BXC Специальные версии

A B C

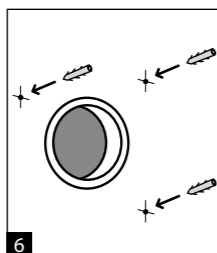
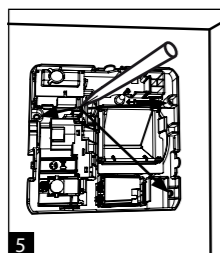
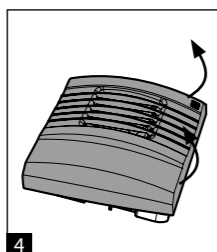
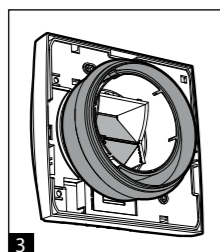
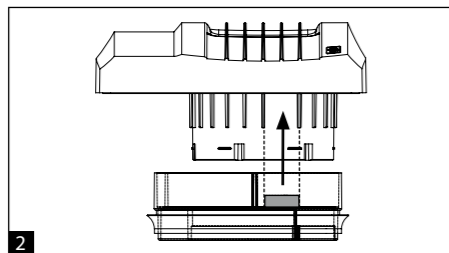
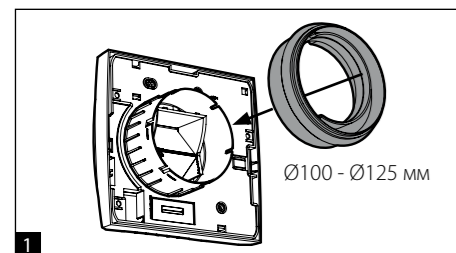
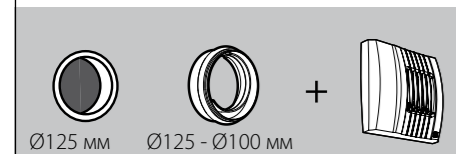
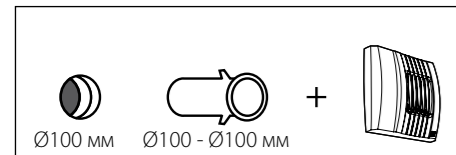
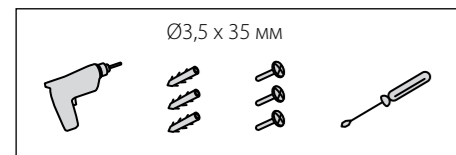

2

CO₂ VOC

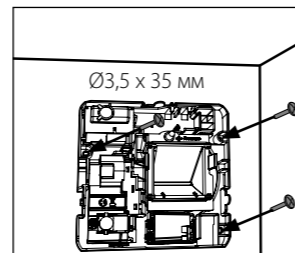
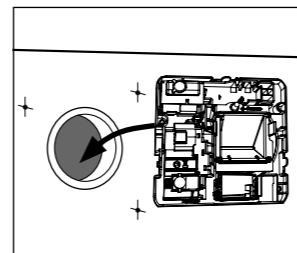
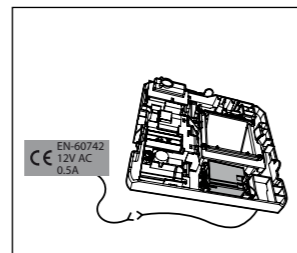

7

8

9

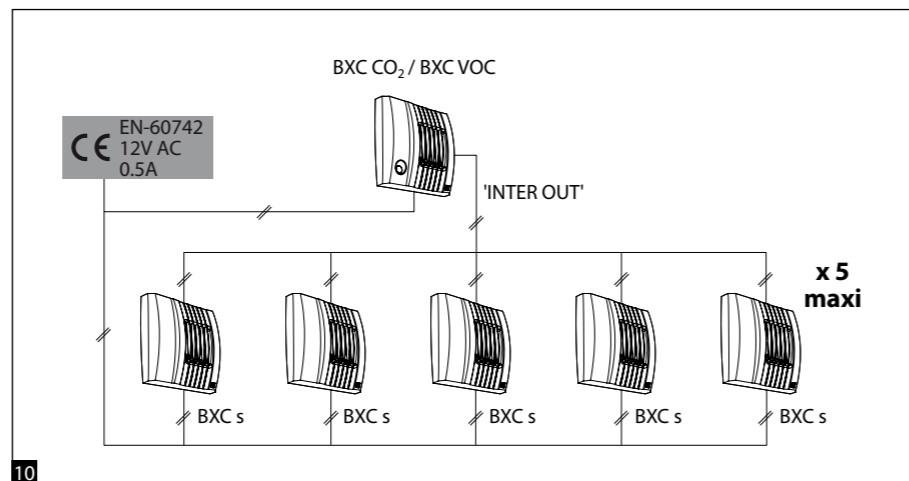

10

3

ТЕСТ

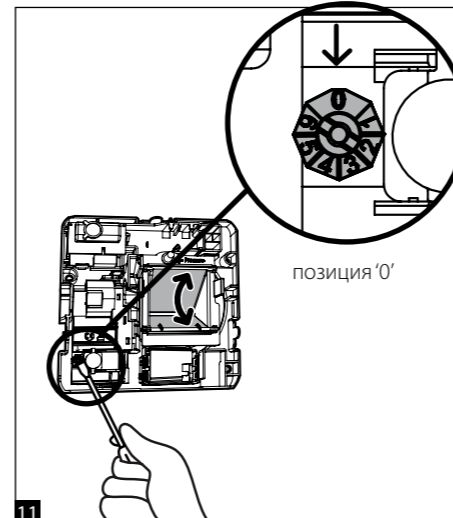

11

Установка чувствительности датчика CO₂/VOC

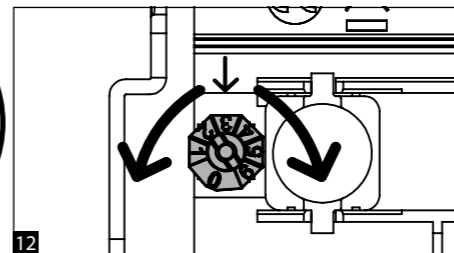

12

Позиция	Уровень CO ₂ /VOC (ppm)
0	ТЕСТ
1	600
2	800
3	1000
4	1200
5	1400
6	1600

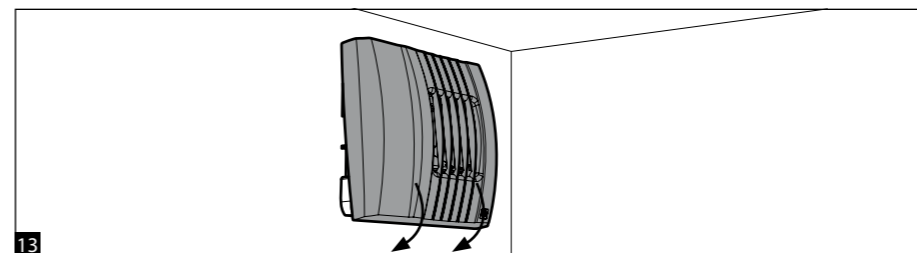

13

4

slave версия 5

Slave версия - BXC s

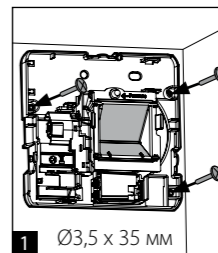

1

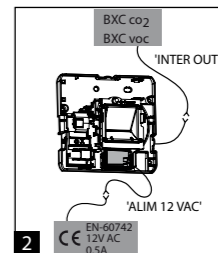

2

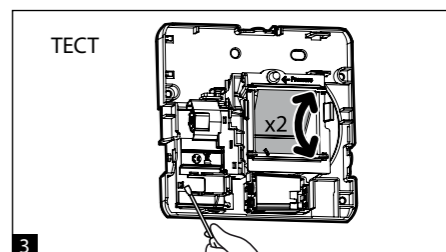

3

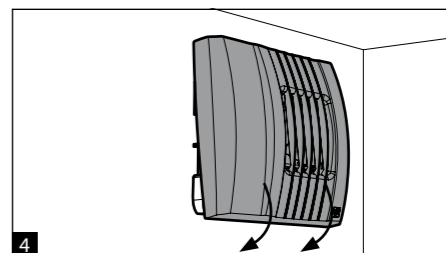

4

Дистанционное управление

2 x 1,5 V AAA LR03

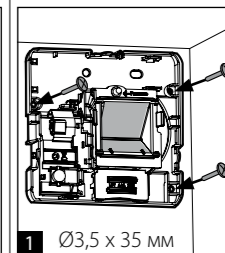

1

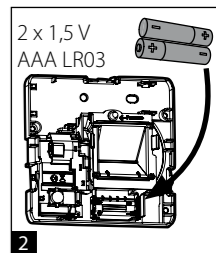

2

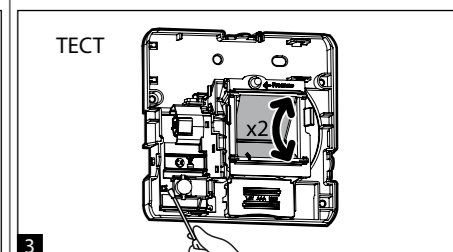

3

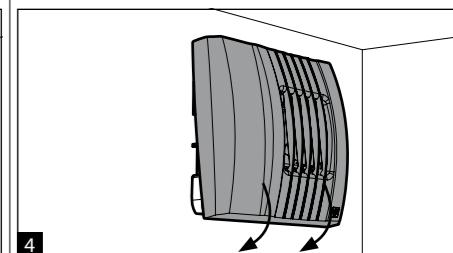

4

5